



USA DESIGN PATENT
US D917,022 S



FOR THE CONTRACTOR

INSTALLATION INSTRUCTIONS



Installation Instructions



Instrucciones De Instalacion



Image Gallery



WARNING! DO NOT ALLOW ACID OR CHEMICAL
WASH SOLUTIONS TO CONTACT THE HIDE PRODUCT.

MATERIALS + TOOLS

IN THE KIT

(A) HIDE SAFETY KEY

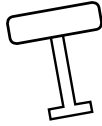

DO NOT LEAVE IN THE COVER!
Pass to the Homeowner. Enables the installed HIDE cover to be safely opened/closed.

Kits 10, 20 & 30mm are single key models.
Kits 40, 50 & 60mm are double key models.

(B) HEIGHT ADJUSTER

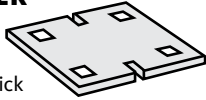

Provides 5mm (3/16") extra height if inlay material is not thick enough to achieve a flush finish with the top of the Inlay Cover.

Suits both single key and double key models.

(C) INLAY COVER

A tray which holds the inlay material e.g. tile, paver, decking, cement.

Single Key model or double key model

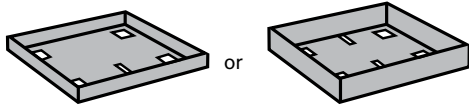

(D) EDGE PROTECTOR

A frame inserted into a recess within the landscaped area. It protects the coping/surrounds from chipping/breakage.

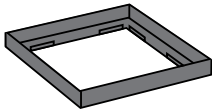

(E) ADHESIVE

HIDE Adhesive to be inserted into a caulking gun. For use when assembling the Inlay Cover.



(F) INFO PACK

Homeowners Manual and Warranty pack. To be passed on after installation.

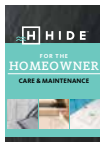

EQUIPMENT YOU'LL NEED

(The type of inlay materials to be fitted will determine the tools required.)



CIRCULAR SAW



ANGLE GRINDER

For cutting a keyway in the inlay material.



PERSONAL PROTECTIVE EQUIPMENT (PPE)



LEVEL WORK SURFACE

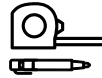

TAPE MEASURE + MARKER



SPONGE + WATER



CAULKING GUN



GENERAL PURPOSE BUCKET



TROWEL



MORTAR BED MIX

For installing the Edge Protector.

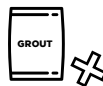

GROUT & SPACERS

If grouting tiled/stone inlay.



EXPANSION JOINT GAP FILLER.

If sealing around the Edge Protector (recommended).

INLAY SOLUTIONS

Depending on where the HIDE product is to be installed, it may run across two different types of landscaping materials. Similarly, it may need to be inserted where grout lines are present, or fitted with an intricate tile pattern.

With a little extra care, the HIDE product can be installed so it is virtually invisible.

GROUT MATCHED



TILE BANDING



INTRICATE PATTERNS



TIMBER DECKING



Installing any material that provides the ability to grip and remove the skimmer box lid (*such as artificial grass*), without using the HIDE Safety Key, may render the Skimmer Lid non-compliant. Please check the standards and regulations in your area, or reconsider the material.



NOTE! If installation varies to Skimmer Lids Pty Ltd recommendations or is used in any way other than specified, warranty and all liabilities are waived. Skimmer Lids Pty Ltd will not be held responsible for any injuries that may occur.



WARNING! Do not allow acid or chemical wash solutions to contact the hide product.

ASSEMBLING THE INLAY COVER

FITTING TILE/STONE INLAY

1 CUT TILE (INLAY) TO SIZE

If using tumbled/chiselled edge tile/stone cut all 4 edges for a better finish. See previous page to view options for aligning inlay and grout lines to coping/surrounds.

⚠ Allow at least 1mm on each edge for expansion and contraction of the steel.

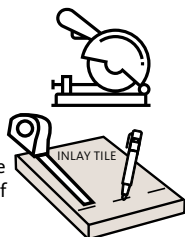

2 MARK UP & CUT KEYWAY AT CENTER

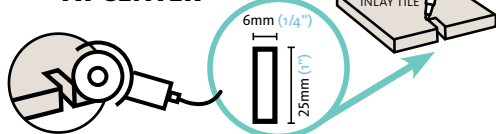

Ensure keyway is positioned on the tile edge which will be closest to the pool. Check that the key fits the keyway before gluing.

⚠ NOTE: Two key models require two keyways.

3 CLEAN & DRY

Failure to complete these steps may result in a weak adhesive bond.

You must insure that bonding materials are fully dry before bonding especially in cold weather.

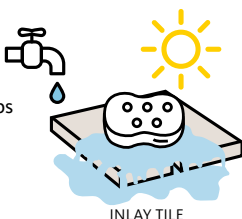

4 CALCULATE THE AMOUNT OF ADHESIVE REQUIRED

by measuring the difference between the internal height of the HIDE Inlay Cover and your Inlay material thickness.

INLAY Cover internal height MINUS INLAY (tile) height = Height difference mm (inch)

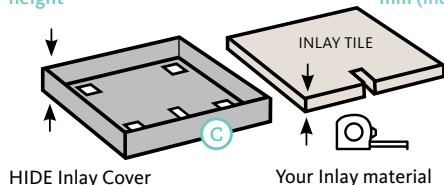

5 HEIGHT DIFFERENCE from step 4

IF HEIGHT DIFFERENCE IS **UNDER 3mm (1/8")**

1 - 2mm (1/16") = Qty 5 x beads 5mm (3/16") wide or

2 - 3mm (1/8") = Qty 7 x beads 8mm (5/16") wide

(For distances over 3mm (1/8") see step 7)

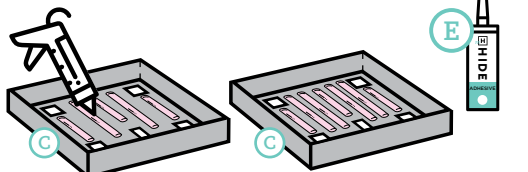

⚠ Avoid placing adhesive within 10mm (3/8") of keyway and drainage holes.

⚠ Ensure the adhesive supports each corner of the inlay material.

Ensure all bonding materials are fully dry.

6 FLIP INLAY COVER **C** OVER

and press down onto inlay (tile):

So that both inlay cover and tile sit upside down flush on a flat surface for 15 minutes to let adhesive stiffen.

Curing time is longer in cold weather.

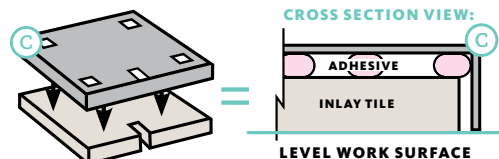

7 HEIGHT DIFFERENCE from step 4

IF HEIGHT DIFFERENCE IS **OVER 3mm (1/8")**

USE THE HEIGHT ADJUSTER SUPPLIED

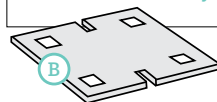

2mm (1/8") Height Adjuster used allowing for two applications of Adhesive.

(See step 8)

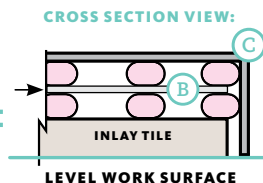

NOTE NUMBER OF KEYWAYS REQUIRED: 10, 20 & 30mm (0.4", 0.8", & 1.2") lids require one keyway cut and 40, 50 & 60mm (1.6", 2", & 2.5") lids require two keyways cut at opposite ends of the stone to suit inlay lid.

8 HEIGHT DIFFERENCE from step 4 WHEN THE HEIGHT DIFFERENCE IS OVER 3mm (1/8")

To calculate TOTAL adhesive to use with the Height Adjuster, remember there will be two lots of adhesive applied ie. adhesive is applied inside the Inlay Cover (C) AND the reverse side of the inlay material (tile).

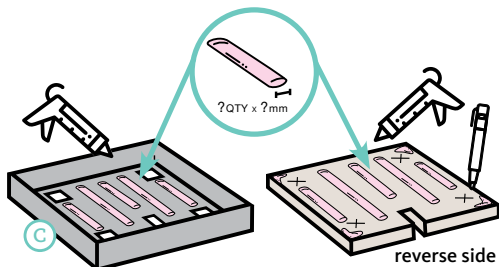

Ensure the adhesive supports each corner OF THE INLAY MATERIAL above and below the Height Adjuster.

⚠ Avoid placing adhesive within 10mm (3/8") of keyway and drainage holes.

Mark their position through the height adjuster with a cross.

9 Place Height Adjuster on inlay (tile), then flip Inlay Cover (C) over and press down onto Height Adjuster (B):

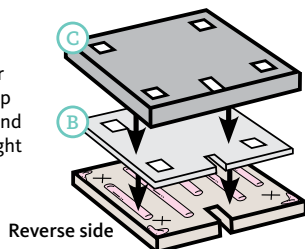

10 PRESS DOWN FOR A LEVEL FINISH

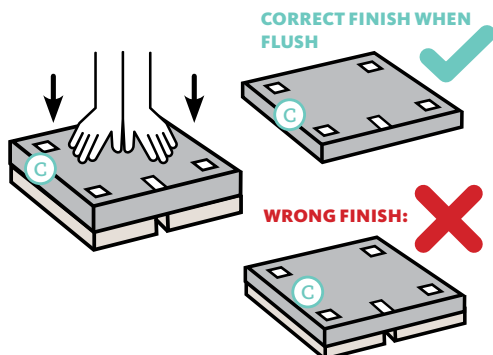

11 WAIT WHILE ADHESIVE STIFFENS

See step 13 as time may vary due to temperature

THEN FLIP RIGHT WAY UP

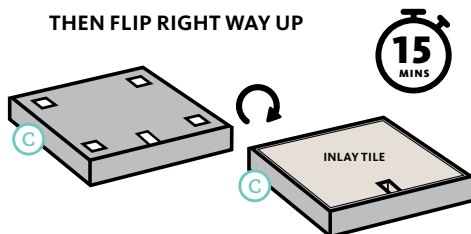

12 CENTER TILE IN THE COVER

CORRECT FINISH:

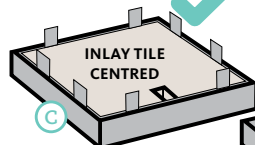

WRONG FINISH:

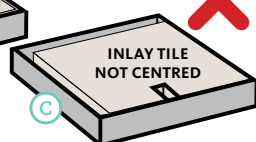

⚠ Make sure the glue has stiffened and remains flush with the inlay cover.

Use tile spacers to center the infill and DO NOT fill the void to allow for expansion and contraction of the steel.

13 LET ADHESIVE SET

Adhesive should not be used in temperatures below 5°C (41°F) and above 40°C (104°F). Curing time will be affected in harsh environments.

- Curing time is longer in cold weather.
- Cure in the shade in hot weather.

14 TO FIT DECKING BOARDS

Apply glue between timber and lid allowing for sufficient clearance for drainage.

For a seamless finish, pattern match timber and grain through the inlay cover.

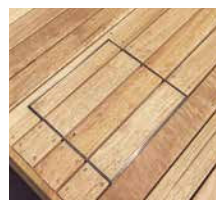

INSTALLING THE EDGE PROTECTOR

POOL PREPARATION

NEW POOLS:

- 15 SET DEPTH** - when laying levelling bed, provide space for edge protector so it will be flush with top of installed tile.

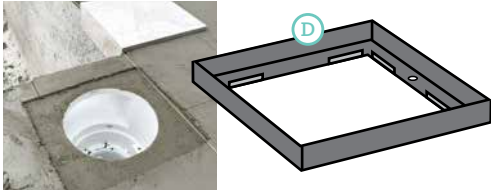

EXISTING POOLS:

- CUTOUT** - mark outline for cutting surrounds and cut depth to match selected edge protector and a mortar bed

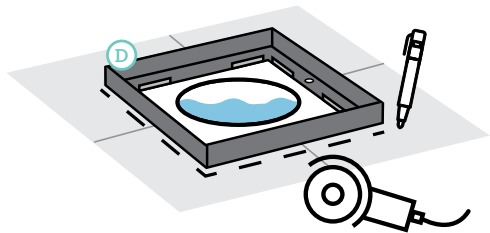

- ⚠ Ensure edge protector is centred over skimmer to mark cutting area. Allow for **1-2mm (1/16")** clearance on all sides.

16 INSTALL MORTAR

Remove debris from recess then fill recess with a mortar bed

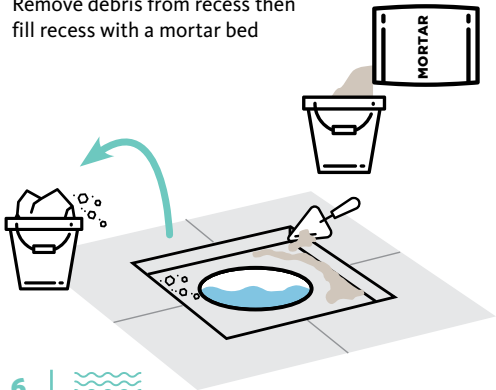

17 PUSH IN EDGE PROTECTOR

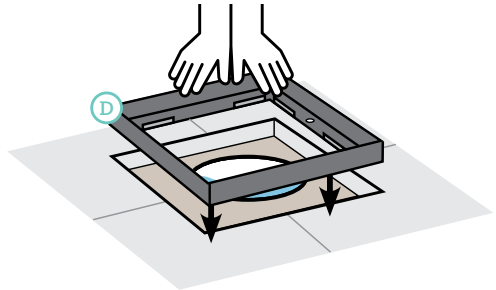

Ensure edge protector sits level with surrounds.
Remove excess mortar.

18 ALLOW MORTAR TO SET

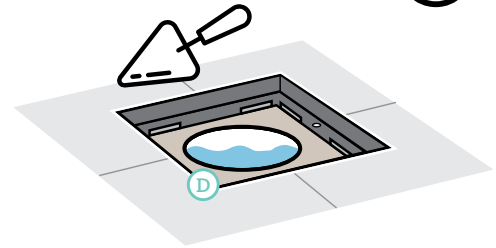

19 EDGE PROTECTOR

TOP VIEW OF INSTALL

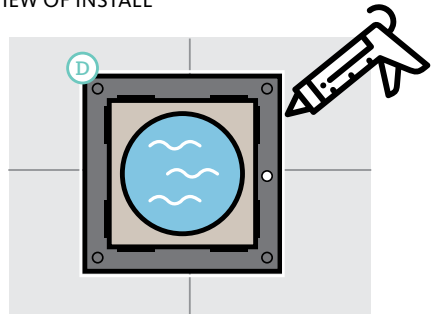

The Edge Protector may be left loose on its mortar bed or filled with an expansion joint gap filler to allow for expansion and contraction of the steel.

CONTRACTOR INFORMATION

EARTHING (BONDING) RULES AND REGULATIONS



HIDE products are constructed from 316 marine grade stainless steel, and are considered a conductive material. Safety regulations vary and you should consult your local authority to determine what rules may apply in your area.

Bonding is the responsibility of the installer, attachment points have been provided to allow for use of bonding devices if required. Check your local regulations to ensure the installation meets electrical safety requirements.

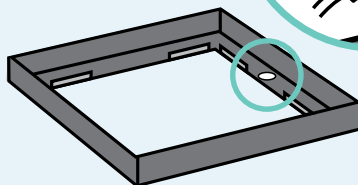

SAFETY FIRST

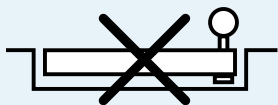

REMOVE KEY FROM COVER

NEVER leave the HIDE Safety Key in the cover for any reason, especially after install.

Leaving the Safety Key in the top of an installed cover may be dangerous, as it enables children to access the Skimmer.

SAFE WORK PRACTICES



ALWAYS be conscious of your and co-workers' safety while assembling and installing the HIDE components.

Personal protective equipment (PPE) must be worn, especially when cutting tiles and using adhesive.

Recommended PPE includes eye and ear protection, gloves, dust mask and safety boots.

PASS KEY TO HOMEOWNER



DO NOT RISK IT - HIDE recommends that once the cover is installed, the Safety Key is passed to the homeowner and is stored securely.

WARNING!

NO ACID / CHEMICAL WASH CONTACT



ACID and chemical washes will cause discolouration and/or rusting on the stainless steel HIDE components. Acid or chemical contact will void the HIDE warranty.